



MOTORPUMP™ — 3500 RPM

60 HERTZ, 5 X 4 X 8 ANSI FLG

105

JP

MOTOR DIMENSIONS

NEMA JP FRAME 3 PHASE 3500 RPM

HP	Type	Frame	D	E	F	O	AB	BG	L	MH
60	ODP	JP326	8.00	6.25	6.00	15.55	11.61	11.00	11.43	0.66
75	ODP	JP364*	9.00	7.00	5.63	18.43	14.57	11.25	12.39	0.75
100	ODP	JP365*	9.00	7.00	6.13	18.43	14.57	11.75	11.89	0.75

* 326JP Shaft
Contact factory for 60-100 HP TEFC

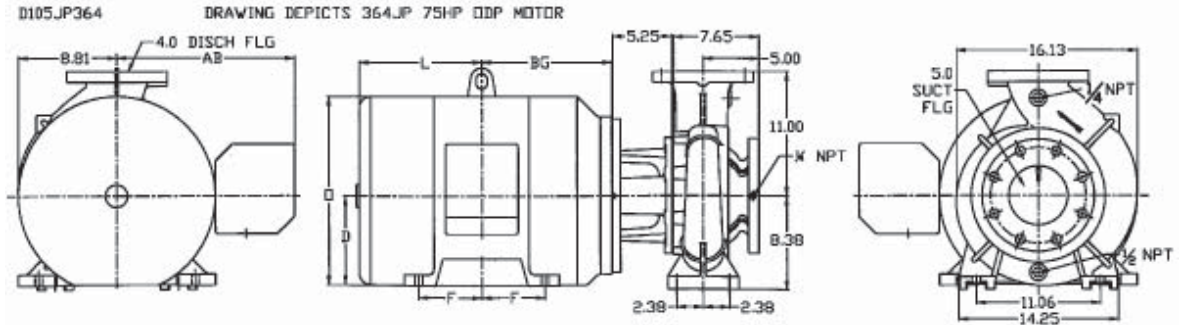

ALL DIMENSIONS IN INCHES.

DRAWING REPRESENTS APPROXIMATE PUMP DIMENSIONS. AUTOCAD DRAWING TO SCALE AVAILABLE FROM FACTORY.

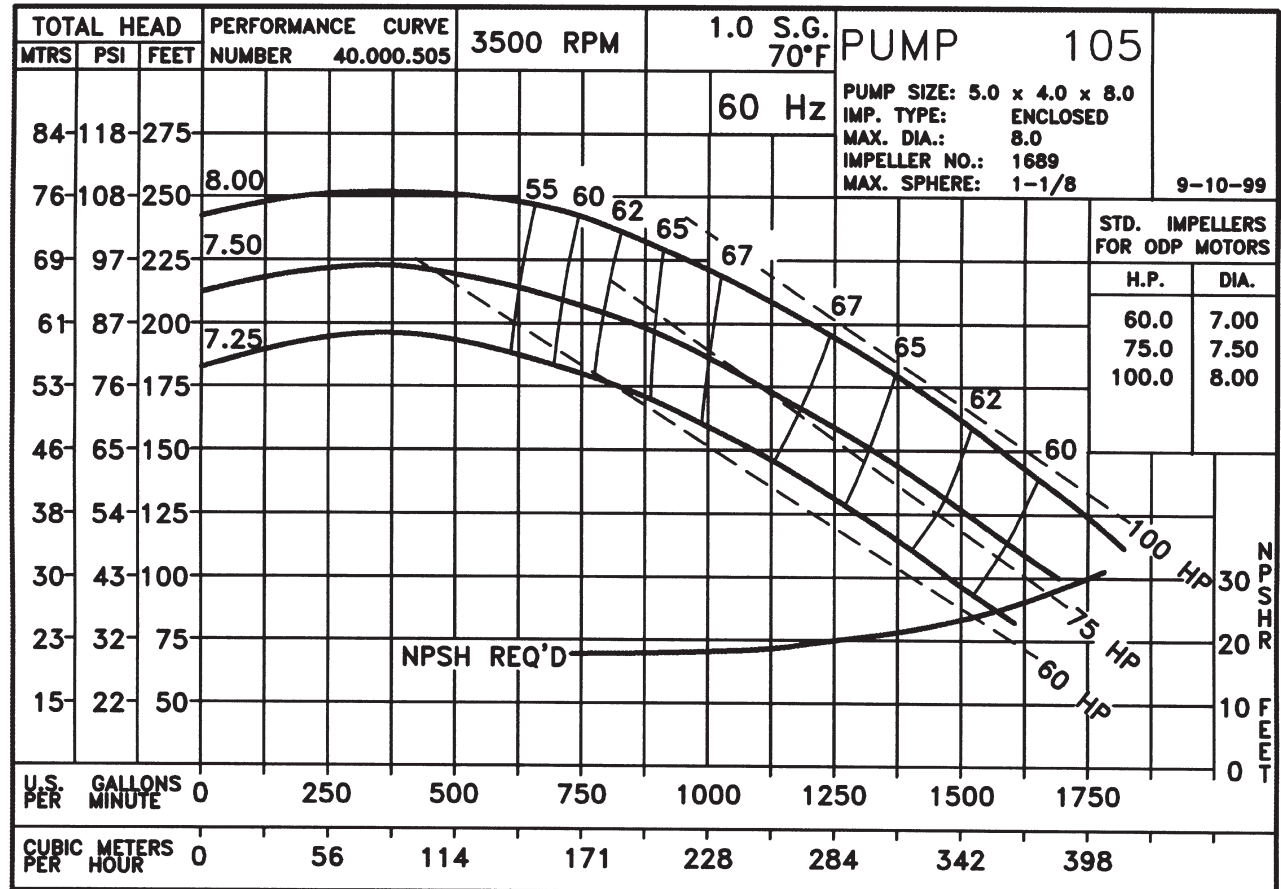
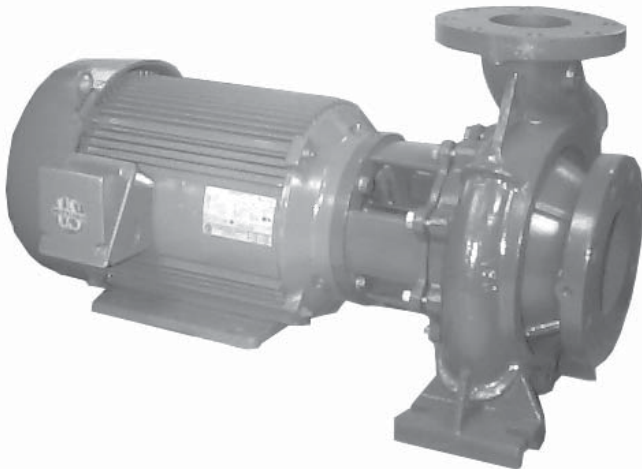

10515TE D105JP364
1053500

105

JP

1053500JP
81.001.242 H6

Pump 105 • Iron • JP Frame • 3500 RPM

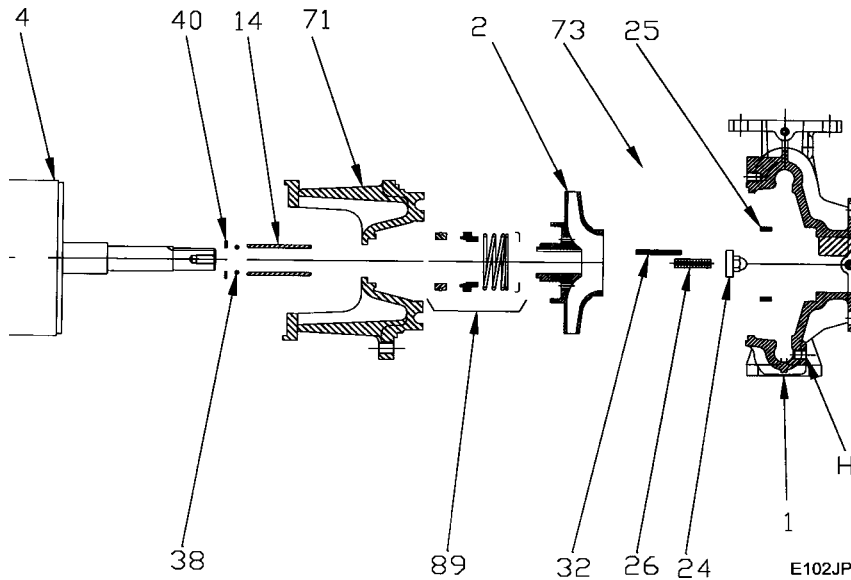

KEY NO.	PART NAME	PUMP NO. 105
1+	CASE, IRON, 5 x 4 FLG	130.000.311X
2	IMPELLER, 1¼" KEYED, ENCLOSED, SPECIFY DIAMETER: IRON	131.000.708
4	MOTOR, JP280/320 MOTOR, JP360	See Chart See Chart
14*	SHAFT SLEEVE, BRONZE SHAFT SLEEVE, STAINLESS	110.000.398 110.000.360
24*	NUT, STAINLESS	110.000.304A
25	WEAR RING, BRONZE WEAR RING, STEEL	103.000.204 103.000.186
26*	STUD, STAINLESS	105.000.385
32*	KEY, STAINLESS	102.000.282
38*	O-RING, SHAFT, BUNA	116.000.218
40*	FLINGER, STAINLESS	104.000.200
71	ADAPTER, IRON, JP280/320/360	137.000.553
73*	GASKET, CASE, FIBER	116.000.261
89*	1¼" SEALS:	
	BN-CARB/CM	101.000.196
	VN-CARB/CM	101.000.216
	VN-CARB/NR	101.000.221
	VN-SIL/SIL	101.000.231
	EPDM-CARB/NR	101.000.196B
	EPDM-SIL/SIL	137.001.555
--	° REPAIR KITS:	
	BN-CARB/CM SEAL	118.000.614
	VN-CARB/CM SEAL (S)	118.000.614A
	VN-CARB/NR SEAL	118.000.614B
	VN-SIL/SIL SEAL (S)	118.000.614D
	EPDM-CARB/NR SEAL	118.000.614C
	EPDM-SIL/SIL SEAL	118.000.614E

* DENOTES COMPONENTS INCLUDED IN REPAIR KIT.

+ INCLUDES BRONZE WEAR RING. FOR STEEL WEAR RING, REPLACE SUFFIX "X" WITH "X1".

° THE REPAIR KIT INCLUDES THE BRONZE SHAFT SLEEVE EXCEPT THE (S) INDICATED, WHICH IS STAINLESS.

Pump 105 • Iron • JP Frame • 3500 RPM

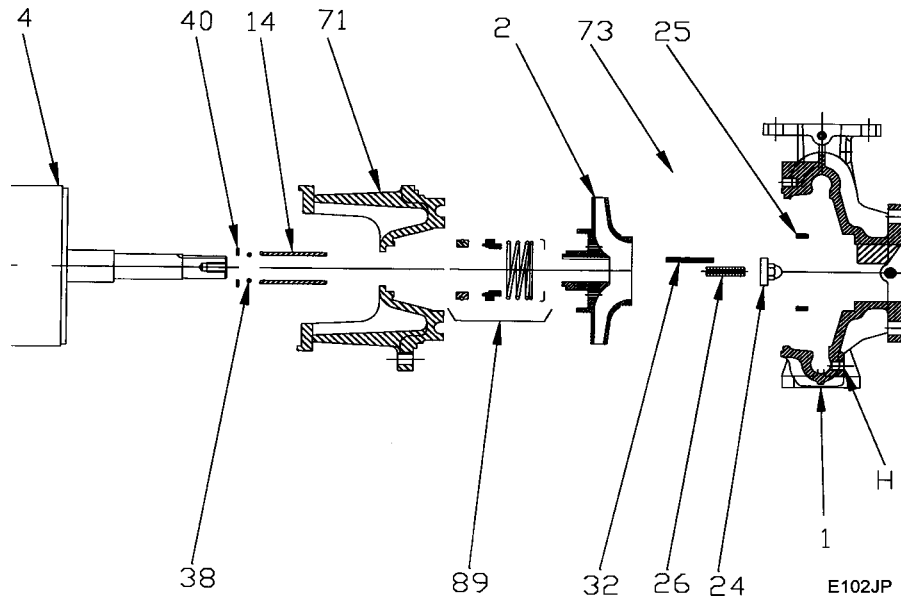

CONSTRUCTION OPTIONS

KEY	PART NAME	STANDARD FITTED	ALL IRON
1	Case	Iron	Iron
2	Impeller	Iron	Iron
14	Shaft Sleeve	Bronze	Stainless
24	Nut	Stainless	Stainless
25	Wear Ring, Case	Bronze	Steel
26	Stud	Stainless	Stainless
27	Wear Ring, Case	Bronze	Steel
32	Key	Stainless	Stainless
38	Shaft O-Ring	BUNA	BUNA
40	Flinger	Stainless	Stainless
71	Adapter	Iron	Iron
73	Gasket, Case	Fiber	Fiber
89	Mechanical Seal, Type 21 BN-CM	Standard	Standard
H	Plug, Drain	Brass	Plated Steel